

透射率计CT-23
使用说明书

产品介绍

使用产品前请仔细阅读本说明书,并妥善保管

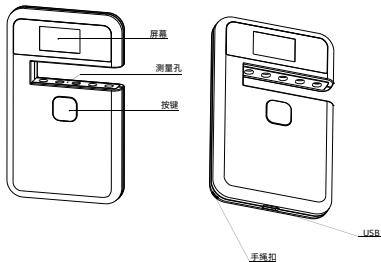

快速使用指南

1. 开机及校准



2. 如何测试

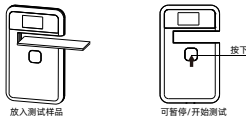

3. 关机



基本参数

| | |
|-------|---|
| 产品名称: | 透射率计 |
| 产品型号: | CT-23 |
| 测量结构: | 透射 |
| 校准: | 手动+自动 |
| 测试指标: | 紫外线 (峰值波长365nm) 可见光 (峰值波长530nm) 红外线 (峰值波长940nm) |
| 测量精度: | ±2% |
| 分辨率: | 0.1% |
| 样品厚度: | 13mm (max) |
| 外形尺寸: | 115* 70* 14mm |
| 测量时间: | 小于1秒 |
| 电池容量: | 750mA |
| 充电参数: | 5V/1A (内置充电锂电池) |
| 屏幕: | 全彩显示屏, 135*240, 1.14英寸 |
| 充电接口: | USB |
| 工作温度: | 0-40°C |
| 湿度: | 小于85%, 不结露 |
| 配件: | USB线, 挂绳, 说明书 |

*参数如有修改,恕不另行通知

保修说明

本产品售后服务严格依据《中华人民共和国消费者权益保护法》《中华人民共和国产品质量法》实行售后三包服务,服务内容如下:

- 自您签收日起7日内,本产品出现《产品性能故障表》所列性能故障的情况,经由本司售后服务中心检测确定,可免费享受退货或换货服务;
- 自您签收日起8-15日内,本产品出现《产品性能故障表》所列性能故障的情况,经由本司售后服务中心检测确定,可免费享受换货或维修服务;
- 自您签收日起12个月内,本产品出现《产品性能故障表》所列性能故障的情况,经由本司售后服务中心检测确定,可免费享受维修服务。

提示信息

因运输过程中需用包装箱保证产品运输安全,建议自签收日起至少保留包装箱30天。

非保修条例

- 未经授权的使用、碰撞、疏忽、滥用、进液、事故改动使用非本产品配件,或撕毁涂改标签防伪标记;
- 已超过三包有效期;
- 因不可抗力造成的破坏;
- 不符合《产品性能故障表》所列性能故障的情况;
- 因人为原因导致非本产品及其配件产生《产品性能故障表》所列性能故障。

警告

- 请勿尝试拆卸或更换仪器内部零件如需服务请联系代理商或官方客服。
- 请勿将仪器放置于热源或直接暴露在炉火旁。
- 若任何液体不小心进入仪器请立即关闭仪器电源。
- 本产品及其内部零件如被儿童误食可能导致窒息等危险。

性能故障表

| 名称 | 性能故障 |
|------|----------------------------------|
| 透射率计 | 1.仪器开关卡滞,不能正常开关 2.仪器显示器无法正常显示 |

合格证
已检验

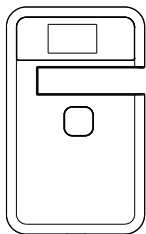

Transmittance Meter CT-23
Operate Manual

Product introduction

Please read this manual carefully before using the product.

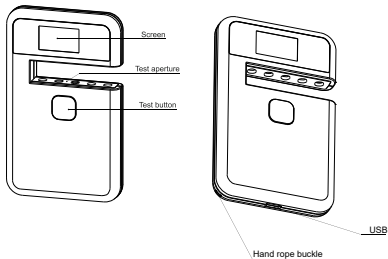

Quick guide

1. Power on and calibration

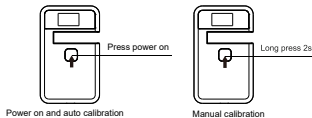

2. How to test

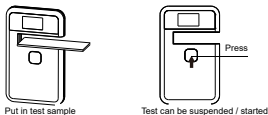

3. Power off



Parameters

| | |
|------------------------|--|
| Product name: | Transmittance Meter |
| Product model: | CT-23 |
| Measurement structure: | Transmission |
| Calibration: | Manual + automatic |
| Test index: | UV (peak wavelength365nm) Visible light (peak wavelength530nm) Infrared (peak wavelength940nm) |
| Measurement accuracy: | ±2% |
| Resolving power: | 0.1% |
| Sample thickness: | 13mm (max) |
| Dimensions: | 115* 70* 14mm |
| Measuring time: | Less than 1 second |
| Battery capacity: | 750mA |
| Charging parameters: | 5V/1A (built-in rechargeable lithium battery) |
| Screen: | Full color display, 135*240, 1.14inch |
| Charging interface: | USB |
| Working Temperature: | 0-40°C |
| Humidity: | Less than 85%, no condensation |
| Standard Accessories: | USB cable,Lanyard,operate manual |

*Parameters are subject to change without notice

Warranty instructions

Reminder

It is recommend that keep the packing box for at least 30 days as the packing box is required to ensure the safety of transportation.

Non warranty regulations

- 1.Unauthorized repair,misuse,accident,modification,use of non-official accessories.
- 2.Instrument is out of warranty.
- 3.Damage caused by force.
- 4.Not the performance failure listed in the product performance failure table.
- 5.Performance failure caused by human factors.

Warning

- Do not attempt to disassemble or replace any part of the equipment. Please contact the agent or official customer service for after sales service.
- Do not place the equipment near heat source or directly expose to the fire.
- If any liquid enters the equipment, please power off the equipment immediately.
- This product contains small parts.It may cause suffocation and other hazards,if swallowed by children,

Product performance failure table

| Name | Performance failure |
|---------------------|--|
| Transmittance Meter | 1.The instrument switch is stuck and cannot be switched normally 2.The instrument display fails to display normally |

